

Organisor



Architect

**Talib Patel
Associates**
Vadodara

BOOKING CONTACT

Ashfaque Hansoti
94286 87266 97236 55577

Opp.rabbani complex,
Dahej by-pass road,
Bharuch.

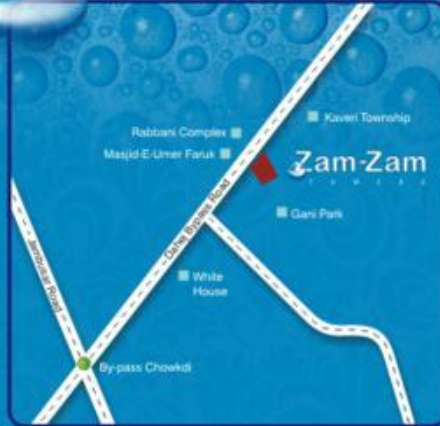

زم-زم

Zam-Zam
T O W E R S





- > G.E.B. & Document Cost extra.
- > The Developers reserve their to make any addition, Alterations & Amendment as may be necessitate time to time.
- > This Brochure shall not be treated as a documents, it is only for information.
- > The Measurements and areas specified in this Brochure are approximate.
- > Possession will be given after full Payment.
- > 10 days notice period will be given for each payment.
- > Deposit Rs. 25,000/- which is Compulsory for each flat for security.



GROUND FLOOR PLAN



25'0" Wide Road

DAHEJ BY-PASS ROAD



TYPICAL FLOOR PLAN



زم-زم

Zam-Zam

T O W E R S

Your home is the place Where you unwind, enjoy and amuse yourself. It's also a place where your sweet little world exists, and where your dreams also live.

Live life the "ZAM ZAM" way.





FIRST FLOOR PLAN

We at ZAM ZAM share your dream, which has inspired us to design

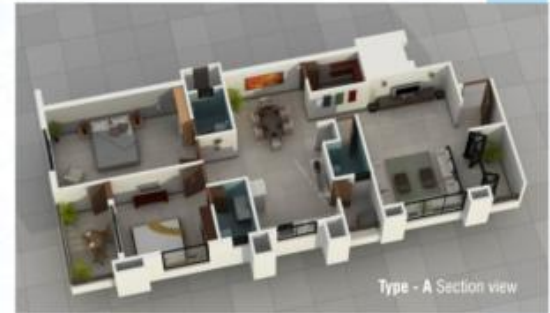



FACILITIES

- 24 Hours Water Supply.
- Lift Facilities for Individual Towers.
- Spacious Children Play area.
- Boundary wall provided on all side.
- Sufficient Parking space provided.
- Silent Power Generator for common Facilities.



SPECIFICATIONS

- Earth quake resistant structure design with high grade M 200 Concert R.C.C. member.
- T.M.T. Height tensile strength steel is to be used which can stand very high loading caused due to Earth quake other natural calamities.
- Water proofing treatment in Toilet, Bathroom & Terrace.
- Windows of good quality lodised Aluminum Section with M.S. Safety Grill.
- Wooden Door frame with main Door of American Masonite and internal flush door.
- Flooring 2'x2' of High Quality joint free Tiles.
- Kitchen Platform with Granite Top and S.S. Sink with glazed tiles dado up to lintel level.
- Bathroom provided with glaze tiles up to full Height.
- Concealed electric point plumbing and drainage.